

# ReidBrace<sup>TM</sup> Installation Guide

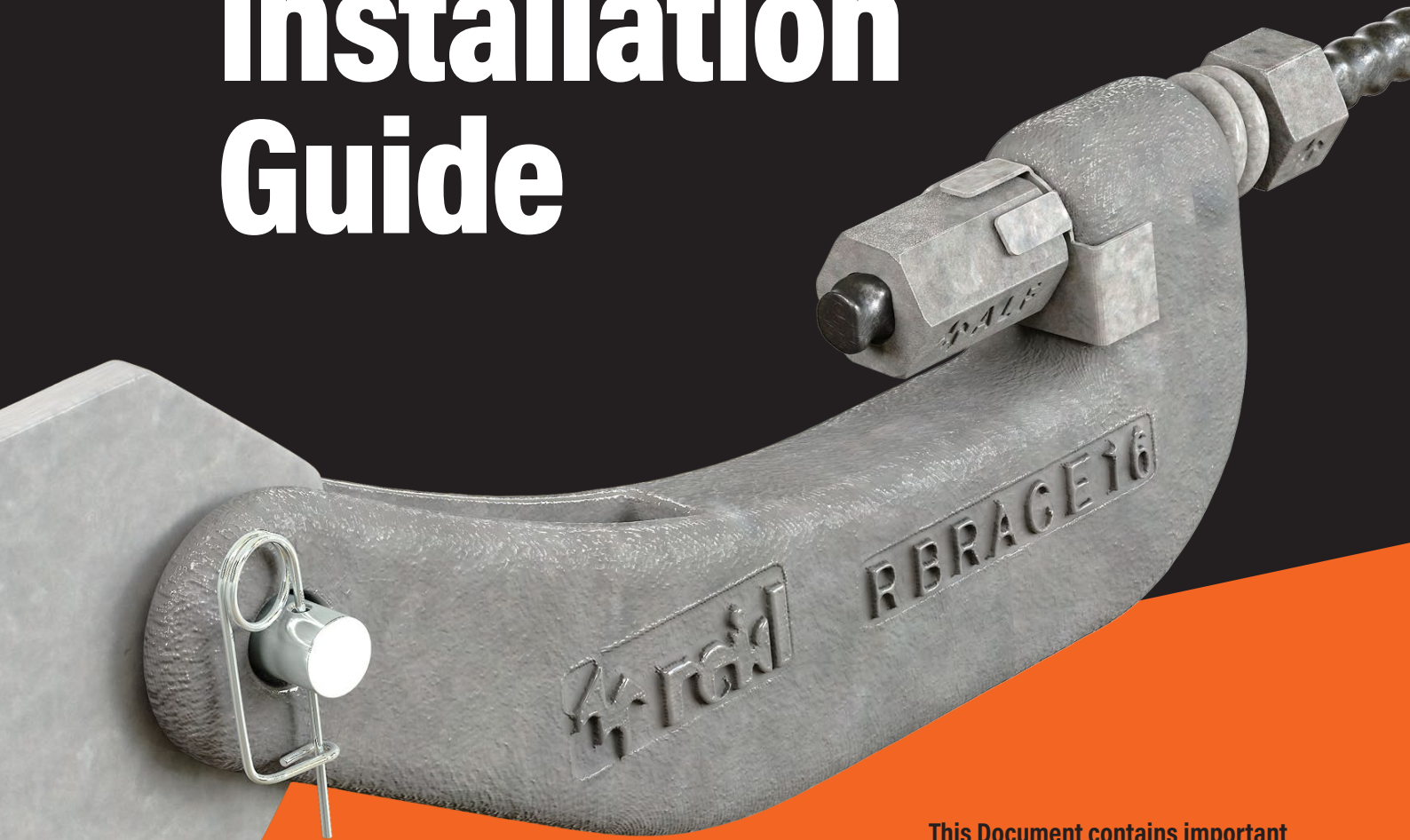

This Document contains important user information with regards to the ReidBrace<sup>TM</sup> Engineered Bracing System

For more information on our products call **0800 72 67 38**  
Or go on our website  
[ramset.co.nz](http://ramset.co.nz)



# ReidBrace™

## Installation Guidelines



### Step 1: Checks

1. Check if all RBRACE components are in the box.
2. Check if the RBRACE fitting flanges will fit onto the steel cleat.

### Boxed Set contents:

1. Reid™ Tension Spring
2. Reid™ Tab Washer
3. RBRACE
4. RBRACE-END
5. Pin and Clip
6. Full nut & Half nut\*

\*full nut may be supplied in lieu of half nut depending on product availability.

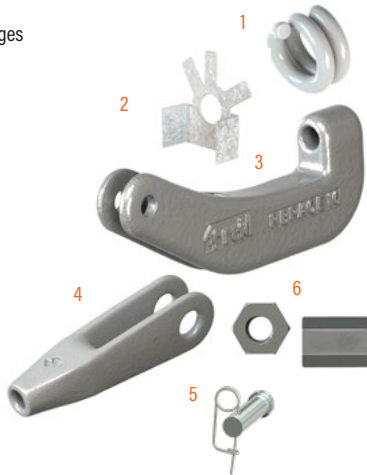

### Step 3: Assemble



1. Insert ReidBar™ into the RBRACE-END fitting and tighten.
2. Insert ReidBar™ Half Nut into the other side of the bar, followed by inserting the tension spring.
3. Slide the RBRACE Fitting onto the ReidBar™, followed by inserting the tab washer onto the ReidBar™ with the tabs facing the nut.

### Step 2: Measure

1. Measure the centre to centre distance between the holes on the steel cleat.
2. Subtract the above length by A+B as per the following table. This is the length of ReidBar™ to be cut.

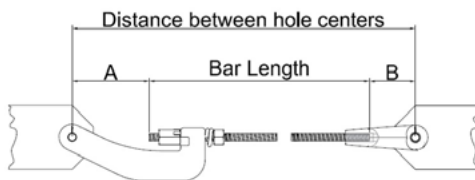

ReidBar™ Size	RBRACE	A ± 5mm	RBRACE__-END	B ± 5mm	A + B (mm)
RB12	RBRACE12/16	135	RBRACE12-END	75	210
RBA16	RBRACE12/16	130	RBRACE16-END	80	210
RBA20	RBRACE20(A)	170	RBRACE20-END(A)	105	275
RB25	RBRACE25	175	RBRACE25-END	125	300
RB32	RBRACE32 V2	200	RBRACE32-V2-END	135	335

\*New Zealand only \*\*Australia only

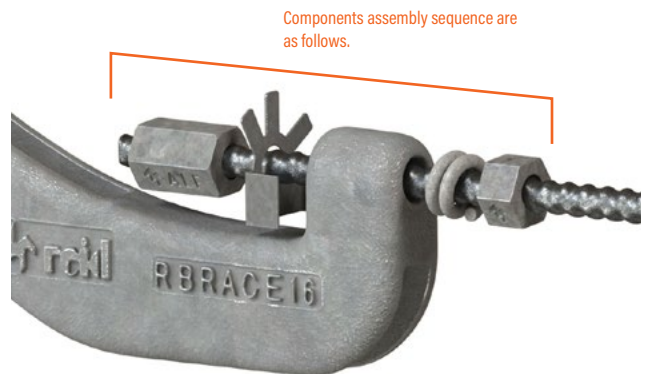

4. Wind ReidBar™ Nut onto the ReidBar™ until it is flush with the end of the ReidBar™. This will give adjustability to the RBRACE fitting upon installation.

# ReidBrace™

## Installation Guidelines

### Step 4: When coupling is required

1. Acquire ReidBar™ Steel Coupler & EPCON™ C8 Epoxy for the corresponding bar size.
2. Inject the required amount of pumps of EPCON™ C8 into one side of the Steel Coupler. Start from the bottom of the thread and draw the nozzle out from the component in a rotating motion as the epoxy is being injected.



3. Screw the Steel Coupler onto the first ReidBar™, and tighten coupler using a wrench to ensure that the ReidBar™ is hard against the stop. Wipe excess filler with cloth/fabric/carton as applicable.



4. Inject the recommended number of pumps of EPCON™ C8 into one side of the Steel Coupler. Start from the bottom of the thread and draw the nozzle out from the component in a rotating motion as the epoxy is being injected.



5. Screw in the second ReidBar™ into the steel coupler, and tighten the bar using a wrench to ensure that the ReidBar™ is hard against the stop. Wipe excess filler with cloth/fabric/carton as applicable.



### Step 5: Install

1. Lift the ReidBrace™ assembly into location.
2. Fix the RBRACE-END fitting onto the steel cleat using the pin supplied in the box set. Clip through hole in pin.



3. Place necessary means to prop the ReidBrace™ assembly so that the sag of the brace is not excessive. A sag of 1 in 100 is recommended as a maximum deflection (refer to HERA: Seismic Design of Steel Structures).
4. Fix the RBRACE fitting onto the steel cleat using the pin supplied in the box set. Fix clip through hole in pin.
5. Adjust the positions of the nuts so that the 1 in 100 maximum deflection criteria is met.
6. Tighten the Nut to fully compress the tension spring. Fold the tab washers onto the ReidBar™ Nut.

### Step 6: Check

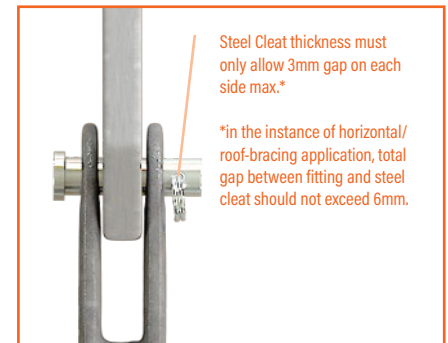

1. ReidBar™ is tightly fastened into the RBRACE-END fitting.
2. The deflection of the brace shall not exceed 1 in 100 of the brace length.

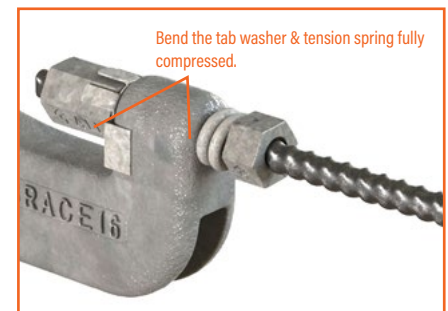

3. Tension spring is fully compressed.
4. Tab washer is folded onto the ReidBar™ Nut.
5. Supplied Pins and Clips are securely fixed to steel.
6. Steel cleat thickness must only allow 3mm gap each side of the ReidBrace™ fitting (or total maximum of 6mm in the case of horizontal/roof-bracing).
7. When coupler is used, ensure that installation & checks as per Step 4 has been carried out.

\*Cyclic testing of ReidBrace™ has been carried out simulating horizontal/roof-bracing application. Therefore in the instance of horizontal/roof-bracing application, it is acceptable for the ReidBrace™ Fitting to sit flush against the steel fixture, as long as the total gap doesn't exceed 6mm.

**Important Disclaimer:** Any engineering information or advice ("Information") provided by Ramset™ in this document is issued in accordance with a prescribed standard, published performance data or design software. It is the responsibility of the user to obtain its own independent engineering (or other) advice to assess the suitability of the Information for its own requirements. To the extent permitted by law, Ramset™ will not be liable to the recipient or any third party for any direct or indirect loss or liability arising out of, or in connection with, the Information.

## Customer Service

---

**Ramset™ New Zealand**  
Sales, Orders and Enquiries  
Tel: 0800 726 738  
Email: [info@ramset.co.nz](mailto:info@ramset.co.nz)  
Web: [www.ramset.co.nz](http://www.ramset.co.nz)

**Website:**  
NZ: [www.ramset.co.nz](http://www.ramset.co.nz)



---

### Ramset™ Trade Centres

<b>Tauranga</b>	Unit 1, 15 Portside Drive, Tauranga
<b>Auckland - Penrose</b>	35 Station Rd, Penrose, Auckland
<b>Auckland - Glenfield</b>	Gate 2, 23-29 Poland Rd, Glenfield, Auckland
<b>Hamilton</b>	15 Somerset Street, Hamilton
<b>Wellington</b>	257 Thorndon Quay, Wellington
<b>Christchurch</b>	120 Montreal St, Christchurch

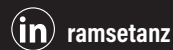

---

**Ramset™ 1 Ramset Drive, Chirside Park 3116**

Information in this document is correct at the time of printing. Readers should contact Ramset™ or consult Ramset™ detailed technical information to ensure product is suitable for intended use prior to purchase. ITW Australia Pty Ltd ABN 63 004 235 063 trading as Ramset™  
© Copyright 2025.™ Trademarks of Cetram Pty. Ltd. Used under license by Ramset™

CB1568

