



Ramset™

ANKASCREW™ SCREW IN ANCHOR

| Removable | Reusable | Medium Tensile and Shear Strength Anchor |

Product Description

The Anka Screw Anchor is a small to medium diameter (rotation setting) medium duty mechanical anchor.

Available in galvanised for exterior applications in a wide range of lengths in M6-M12 sizes (6 - 12mm holes).



Installation Features & Benefits

- Easy and fast to install, remove and reuse
- Flanged head does not sink into soft fixtures making removal easy
- Easy and fast to remove and reuse
- Suitable for installation with impact wrenches
- No protruding metal components to cut off when removed
- Suitable for a wide range of fixture thicknesses

Performance Features & Benefits

- Installation close to concrete edges does not burst the concrete
- Good performance with small edge and anchor spacing distances
- Suitable for a range of fixture thicknesses up to 100mm
- Design allows reuse up to 3-5 times

Principal Applications

- The AnkaScrew is ideal for small to medium load applications where the anchor needs to be installed with small edge distances or anchor spacings. It also has the benefit of being fully removal and reusable
- Meets the 15kN requirement for Proprietary Bracing Systems
- Securing formwork for tilt-up panels
- Securing small machinery
- Fastening into solid brick in lighter duty applications

Installation Procedure

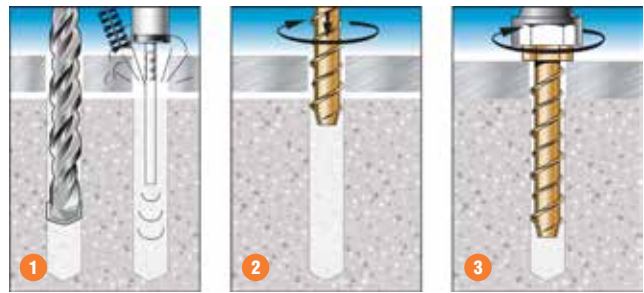

1. Drill hole to correct diameter and depth. Clean thoroughly with brush. Remove debris by way of vacuum or hand pump, compressed air etc.
2. Using a socket wrench, screw the Anka Screw into the hole using slight pressure until the self tapping action starts.
3. Tighten the Anka Screw. If resistance is experienced when tightening, unscrew anchor one turn and re-tighten. Ensure not to over tighten.

Product Options, Dimensions and Installation Information

Part Number	Head Style	Durability Options	Box Qty	Length (mm)	Bolt Dia (mm)	Concrete Hole Dia (mm)	Tightening Torque (Nm)	Socket/Wrench Size AF (mm)	Fixture Clearance Hole Dia (mm)
AS06050GH	Bolt	GH	100	50					
AS06075GH	Bolt	GH	100	75	6	6	25	10	8
AS06100GH	Bolt	GH	100	100					
AS08060GH	Bolt	GH	100	60					
AS08075GH	Bolt	GH	100	75	8	8	40	12	10
AS08100GH	Bolt	GH	100	100					
AS10060GH	Bolt	GH	50	60					
AS10075GH	Bolt	GH	50	75					
AS10100GH	Bolt	GH	50	100	10	10	60	14	12
AS10150GH	Bolt	GH	25	150					
AS12075GH	Bolt	GH	50	75					
AS12100GH	Bolt	GH	25	100	12	12	80	17	15
AS12150GH	Bolt	GH	20	150					

Independent Appraisal



Tension Zone



Cyclic Loads



Shock Load



Fire Applications



Pull Down



Close Spacings



Water System



Chemical Creep Tested



Zinc Plating



Galvanised Plating





Ramset™

ANKASCREW™ SCREW IN ANCHOR

| Removable | Reusable | Medium Tensile and Shear Strength Anchor |

Performance Information



IF YOUR DIMENSIONS ARE LESS THAN THE TABLED “DIMENSIONS TO ACHIEVE CAPACITIES”

Refer to Ramset Specifiers Anchoring Resource Book for the performance values.

Or scan QR Code to link to the Specifiers Anchoring Resource Book.



Part Number		Installation (mm)		Dimensions to Achieve Capacities (mm)			Tensile Capacity ϕN_{uc} (kN)		
Part Number (Bolt Dia)	Fixture Thickness	Hole Depth	Min Concrete Thickness	Min Anchor Edge Distance	Min Anchor Spacing	20 MPa Concrete	32 MPa Concrete	40 MPa Concrete	
AS06050GH (M6)	5	57	82	24	48	5.8	6.9	7.4	
	10	52	77	24	48	5.1	6.0	6.5	
	20	42	67	24	48	3.7	4.3	4.7	
AS06075GH (M6)	5	82	107	24	48	9.6	11.3	12.3	
	20	67	92	24	48	7.3	8.6	9.3	
	45	42	67	24	48	3.7	4.3	4.7	
AS060100GH (M6)	5	107	132	24	48	13.6	16.1	17.4	
	45	67	92	24	48	7.3	8.6	9.3	
	70	42	67	24	48	3.7	4.3	4.7	
AS08060GH (M8)	5	71	96	32	64	8.3	9.8	10.6	
	10	66	91	32	64	7.3	8.6	9.3	
	20	56	81	32	64	5.5	6.4	7.0	
AS08075GH (M8)	5	86	111	32	64	11.4	13.4	14.5	
	20	71	96	32	64	8.3	9.8	10.6	
	35	56	81	32	64	5.5	6.4	7.0	
AS080100GH (M8)	5	111	136	32	64	16.9	20.0	21.6	
	35	81	106	32	64	10.3	12.2	13.1	
	60	56	81	32	64	5.5	6.4	7.0	
AS10060GH (M10)	5	75	100	40	80	9.0	10.6	11.4	
	10	70	95	40	80	7.9	9.3	10.0	
AS10075GH (M10)	5	90	115	40	80	12.6	14.8	16.0	
	10	85	110	40	80	11.3	13.4	14.5	
	25	70	95	40	80	7.9	9.3	10.0	
AS10100GH (M10)	5	115	140	40	80	19.3	22.8	24.6	
	25	95	120	40	80	13.9	16.3	17.7	
	50	70	95	40	80	7.9	9.3	10.0	
AS10150GH (M10)	5	165	190	40	80	34.9	41.1	44.5	
	50	120	145	40	80	20.7	24.4	26.4	
	100	70	95	40	80	7.9	9.3	10.0	
AS12075GH (M12)	5	94	119	48	96	14.0	16.6	17.9	
	15	84	109	48	96	11.2	13.2	14.3	
AS12100GH (M12)	5	119	144	48	96	21.9	25.9	28.0	
	20	104	129	48	96	17.1	20.1	21.8	
	40	84	109	48	96	11.2	13.2	14.3	
AS12150GH (M12)	5	169	194	48	96	40.7	47.9	51.8	
	45	129	154	48	96	25.4	29.9	32.4	
	90	84	109	48	96	11.2	13.2	14.3	

Stainless Steel

Floor Applications

Wall Applications

Overhead Applications

Dry Holes

Damp Holes

Flooded Holes

Hollow Substrates

Hammer Drill

Cored Holes

Through Fixed

Fully Removable

